



LARKSPUR DRIVE, FEATHERSTONE



Ground Floor

Entrance Porch

Having uPVC / double glazed French doors, laminate flooring and a door to the hall.

Hall

Enter the property via a uPVC / double glazed front door and having wall lighting, a central heating radiator, carpeted flooring as well as a carpeted stairway to the first floor and a door to the lounge.

Lounge

15' 1" x 11' 9" (4.59m x 3.58m)

Having a uPVC / double glazed window to the front aspect, wall lighting, a central heating radiator, a gas fire with a fireplace surround, carpeted flooring, a television aerial point and a door to the kitchen/diner.

Kitchen/Diner

10' 7" x 15' 2" (3.22m x 4.62m)

Being fitted with a range of gloss handleless wall, base and drawer units with laminate worksurface over and matching upstands and having a uPVC / double glazed window to the rear aspect with a Venetian blind fitted, a ceiling light point, wall lighting, a central heating radiator, a one and a half bowl sink with a mixer tap fitted and a drainer unit, an electric oven integrated in a tall cabinet with an integrated microwave above, a four-burner gas hob with a stainless steel chimney style extraction unit over, a peninsula, plumbing for a washing machine, laminate flooring, a door to a pantry, a uPVC - double glazed door to the side aspect opening to the rear garden and uPVC / double glazed sliding patio doors to the rear aspect opening to the conservatory.

Conservatory

10' 7" x 8' 11" (3.22m x 2.72m)

Being constructed from a low-level brick wall and uPVC / double glazed windows to the side and rear aspects fitted with vertical blinds. Also having a ceiling light point with a fan, laminate flooring and uPVC / double glazed French doors to the rear aspect opening to the garden.

First Floor

Landing

Having an obscured uPVC / double glazed window to the side aspect, a ceiling light point, access to the loft space, carpeted flooring, an airing cupboard and doors to the three bedrooms and the bathroom.

Bedroom One

8' 4" x 13' 10" (2.54m x 4.21m)

Having a uPVC / double glazed window to the front aspect, a ceiling light point, a central heating radiator, a fitted wardrobe with sliding mirror doors and carpeted flooring.

Bedroom Two

9' 10" x 6' 5" (2.99m x 1.95m)

Having a uPVC / double glazed window to the rear aspect, a ceiling light point, a central heating radiator, a fitted wardrobe with sliding mirror doors and carpeted flooring.

Bedroom Three

9' 10" x 6' 5" (2.99m x 1.95m)

Having a uPVC / double glazed window to the front aspect, a ceiling light point, a central heating radiator and carpeted flooring.

Bathroom

Having an obscured uPVC / double glazed window to the rear aspect, a ceiling light point, a central heating radiator, a WC, a wash hand basin, fully tiled walls, laminate flooring and a bath with an electric shower over.

Outside

Garage

18' 3" x 8' 7" (5.56m x 2.61m)

Being a detached garage, which has power, lighting, side-hinged doors to the front aspect and a uPVC / double glazed door to the rear aspect opening to the garden.

Front

Having a large concrete print driveway suitable for parking multiple vehicles, outside courtesy lighting, access to the garage and access to the rear of the property via a wooden side gate.

Rear

Being beautifully landscaped and having a lawn, a decked area, a patio dining area, a cold-water tap, outdoor lighting, a gravel border, various bushes, shrubs and plants, a bar gazebo, access to the rear aspect of the garage and access to the front of the property via a wooden side gate.

Agents Notes

Tenure – Freehold
Council Tax Band - C







* An immaculately presented three-bedroom semi-detached home in a desirable area *

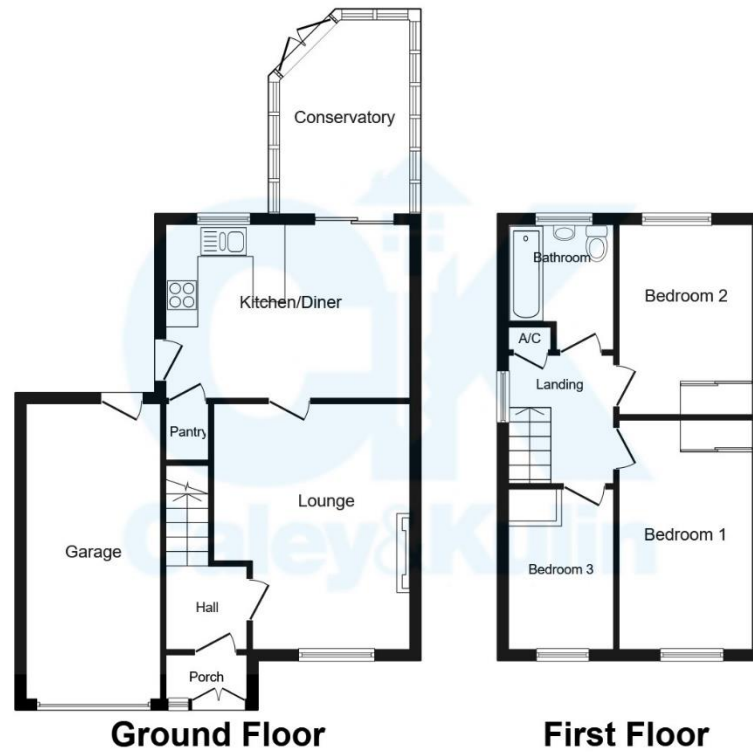

This plan is for illustration purposes only and may not be representative of the property. Plan not to scale. Powered by PropertyBox

To view this property please contact Caley & Kulin on:
Cannock: 01543 396880 **Stafford:** 01785 559880
E-mail: info@candk.co.uk

Staffordshire House, Clay Street, Penkridge, Stafford, ST19 5AF

View this property online candk.co.uk

Council Tax Band: C
EPC Rating: Awaiting EPC
Tenure: Freehold
Version: CK 1042/001



Find us on facebook
facebook.com/candk.co.uk



These particulars are not to form part of a Sale Contract owing to the possibility of errors and/or omissions. Prospective purchasers should therefore satisfy themselves by inspection or otherwise as to their correctness. All fixtures, fittings, chattels and other items not mentioned are specifically excluded unless otherwise agreed within the Sale Contract documentaries or left in situ and gratis upon completion. The property is also sold subject to rights of way, public footpaths, easements, wayleaves, covenants and any other matters which may affect the legal title. The Agent has not formally verified the property's structural integrity, ownership, tenure, acreages, estimated square footage, planning/building regulations status or the availability/operation of services and/or appliances. Therefore prospective purchasers are advised to seek validation of all the above matters prior to expressing any formal intent to purchase.

See all our properties at www.candk.co.uk | www.rightmove.co.uk

